

Versatile™ 4C Mailbox, 4C15S-3P

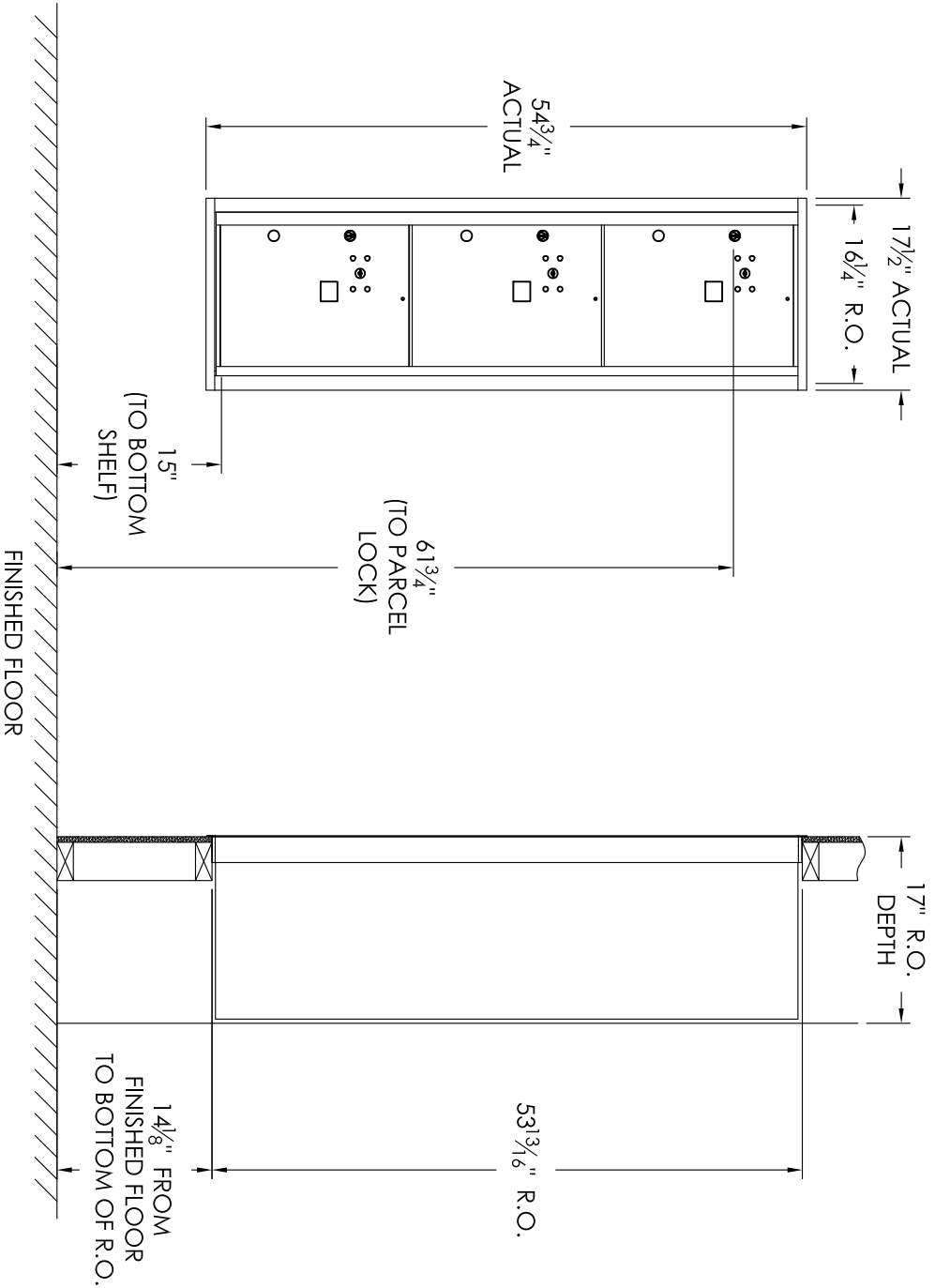

COMPARTMENT CHART

| DESCRIPTION | COMPARTMENT | COMPARTMENT SIZE | QTY. |
|-------------|-------------|-----------------------|------|
| PARCEL | PLUS | 17" H x 12" W x 15" D | 3 |

PRODUCT SERIES: VERSATILE™ 4C FRONT LOAD MAILBOX

AF FLORENCE
manufacturing company

5935 Corporate Drive • Manhattan, KS 66503
 www.florencemailboxes.com • (800) 275-1747
 A GIBRALTAR INDUSTRIES COMPANY

| MODEL | REV |
|----------|-----|
| 4C15S-3P | D |

| SCALE | LAST REV DATE |
|-------|---------------|
| NONE | 5/15/14 |

| DRAWING NUMBER | DRAWN BY |
|----------------|----------|
| 4C15S-3PCS | RS |

Notes:

- This module meets the USPS STD-4C requirements for installation defined below when the mailbox is installed per the dimensions provided on this drawing.
 - At least one customer compartment shall be positioned less than 48" above finished floor (AFF).
 - No parcel locker (interior bottom shelf) shall be positioned less than 15" AFF.
 - No patron (tenant) lock shall be positioned more than 67" AFF.
 - No customer compartment (interior bottom shelf) shall be positioned less than 28" AFF.
 - The USPS Arrow lock shall be positioned 36"-48" AFF.
- This 4C mailbox can also be used for private applications.
- The rough opening width for multi-unit 4C installations = (the sum of all actual unit widths) - 1 7/8".